

Air-Operated Double Diaphragm Pumps



3/4" TC-X202 Series

TC-X202-Series 3/4" pumps are available in Glass Fiber Reinforced Polypropylene (PPG) with a PPG Kynar (PVDF) air motor section for exceptional chemical resistance. Featuring the new Looped C® Air Motor technology. Both Flange and Threaded connections available.

Maximum Flow Rate: 31.7 GPM (120 L/Min)
 Maximum Discharge Head: 230 ft (70 m)
 Available in: Filled Polypropylene (PPG), PVDF (Kynar®)
 Spool valve type: Looped C® Spring Valve
 Check Valves: Ball type
 Certification: CE



SPECIFICATIONS				
Material Code*	P "X"	V "X"	PT	VT
Max Flow Rate	31.7 GPM (120 LPM)		26.4 GPM (100 LPM)	
Max Air Pressure	100 PSI (0.7 MPa)			
Max Air Consumption	42.4 scfm (1200 L/min)		49.5 scfm (1400 L/min)	
Supply Air Pressure Range ¹	30-100 PSI (0.2 - 0.7 MPa)			
Liquid Discharge Volume per cycle	12 oz (350 mL)		8 oz (240 mL)	
Suction x Discharge	NPT 3/4" / 3/4" ANSI flange 150 lb / JIS Flange 10k40A			
Weight	15.4 lbs (7.0kg)	19.8 lbs (9.0kg)	15.4 lbs (7.0kg)	19.8 lbs (9.0kg)

* See Chart and Model Number nomenclature on back page for materials
 Note 1: A supply air pressure of 30 PSI (0.2 MPa) or more is required to operate the pump.
 Pump Liquid Temperature Range: 32-140°F (0 - 60°C)
 Ambient Temperature Range: 32-158°F (0 - 70°C)
 Slurry Recommendation: 0.08" (2 mm) or less
 Viscosity Limit: Suction lift ~3000 cps (3 Pa-s) Force in ~8000 cps (8 Pa-s) (Please contact your distributor for more details)

PERFORMANCE CURVES

— Flow
 - - - Air

Conditions:
 4" (10 cm) flooded suction.
 Ambient temperature: 68-77°F (20-25°C)
 Liquid temperature: 68-77°F (20-25°C)

TC-X202P"X"/V"X" (except T)

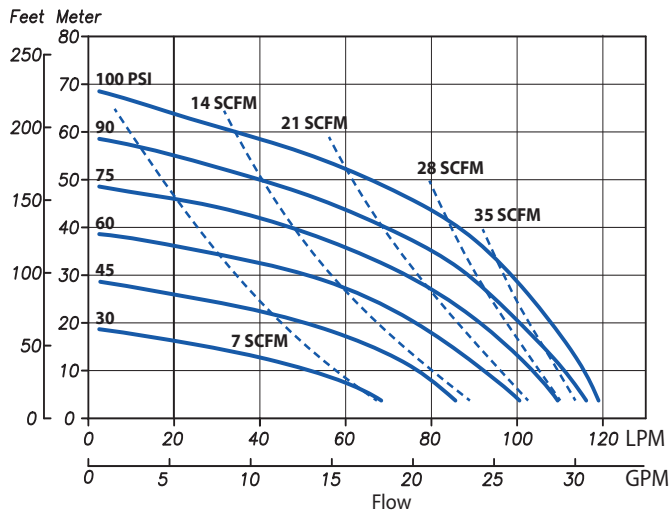

TC-X202PT/VT

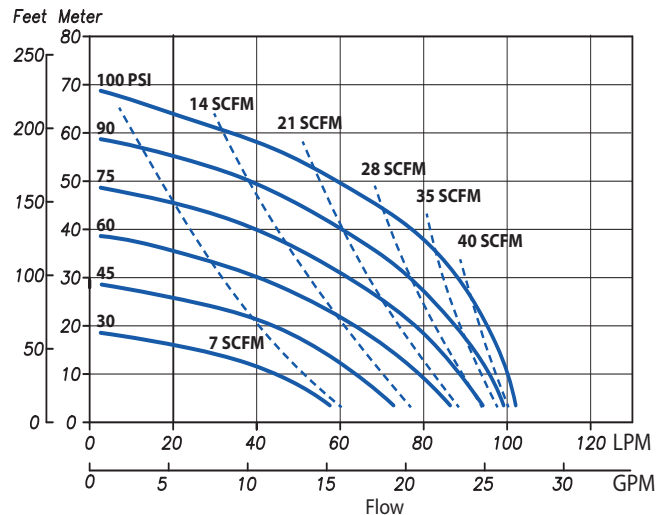

3/4" TC-X202 Series

WET END MATERIALS						
Code	Pump wetted parts	Diaphragm	Ball Valve / Valve Seat	Valve Stopper	Outer Diaphragm Plate	Center Body
PC	PPG	Neoprene™	Neoprene™/BUNA	AL	PPG (SCS13*)	PPG
PN		BUNA	BUNA			
PE		EPDM	EPDM			
PV		Viton®	Viton®			
PT		PTFE	PTFE			
PH		Hytre ™	Hytre ™ /BUNA			
PS		Santoprene®	Santoprene® /EPDM			
VE	PVDF	EPDM	EPDM	PVDF	PVDF (SCS13*)	
VV		Viton®	Viton®			
VT		PTFE	PTFE			
VH		Hytre ™	Hytre ™ /BUNA			
VS		Santoprene®	Santoprene® /EPDM			

Neoprene™ Chloroprene Rubber (CR)
 BUNA Nitrile Rubber (NBR)
 EPDM Ethylene propylene diene monomer (Norden™)
 Viton® Fluoroelastomer (FKM)
 PTFE Polytetrafluoroethylene (Teflon®)
 Hytre|™ Thermoplastic Polyester Elastomer (TPEE)
 Santoprene® Thermoplastic PolyOlefin (TPO)
 PPG Glass Fiber Reinforced Polypropylene
 PVDF Polyvinylidene Fluoride (Kynar®)
 AL Aluminum
 SCS13 Cast Stainless Steel Grade*

* SCS13 Insert material

DIMENSIONS

TC-X202P/V (NPT)

TC-X202P/V (ANSI Flange)

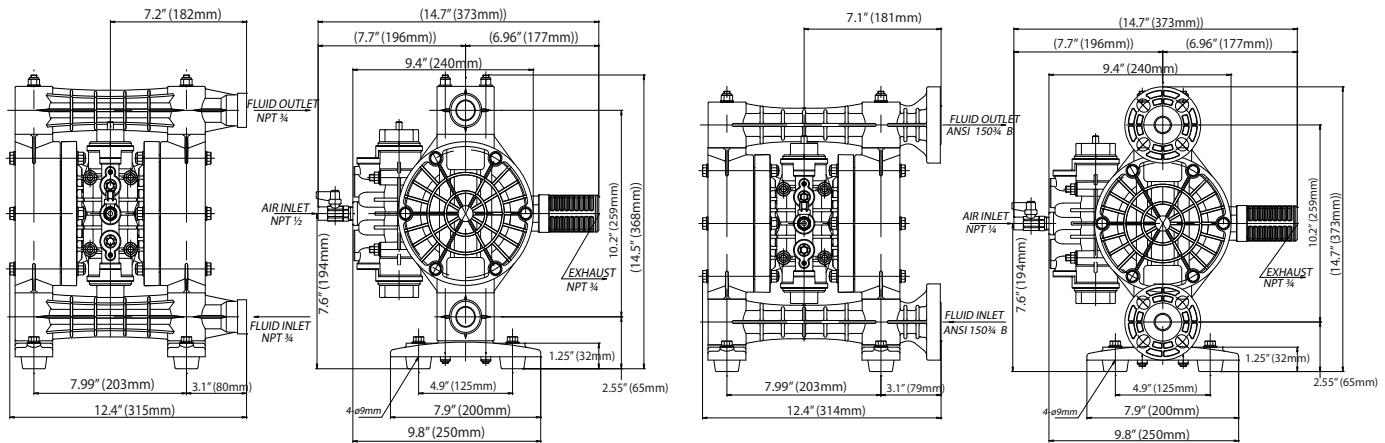

MODEL NUMBER NOMENCLATURE

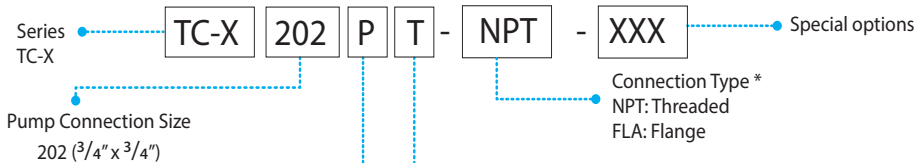

Pump Body Material (wetted)
 P: PPG
 V: PVDF

Diaphragm Material
 C: Neoprene™ (CR)
 N: BUNA (NBR)
 E: EPDM
 V: Viton® (FKM)

T: PTFE
 H: Hytre|™ (TPEE)
 S: Santoprene® (TPO)