

Air-Operated Double Diaphragm Pumps



1/2" TC-X151 Series

A pump specially designed for reliable start/stop and running against dead head & high pressure type applications.

Maximum Flow Rate: 14.3 GPM (54 L/Min)
 Maximum Discharge Head: 230 ft (70 m)
 Available in: Stainless Steel, PVDF, Polyoxymethylene (Acetal®), Aluminum,
 Glass Fiber Reinforced Polypropylene
 Spool valve type: C-Spring Valve
 Check valves: Flat Valve & Ball options
 Certification: CE, ATEX (select models)



SPECIFICATIONS

Material Code*	A"X"	S"X"	G"X"	V"X"
Max Flow Rate	14.3 GPM (54 LPM)		13.2 GPM (50 LPM)	
Max Air Pressure	100 PSI (0.7 MPa)			
Max Air Consumption	15.9 scfm (450 L/min)		14.1 scfm (400 L/min)	
Supply Air Pressure Range ¹	30-100 PSI (0.2 - 0.7 MPa)			
Liquid Discharge Volume per cycle	2.4 oz (70 mL)			
Connection Suction x Discharge	NPT 1/2"			
Weight	9.04 lbs (4.1 kg)	13.9 lbs (6.3 kg)	7.7 lbs (3.5 kg)	9.48 lbs (4.3 kg)

* See Chart and Model Number nomenclature on back page for materials
 Note 1: A supply air pressure of 30 PSI (0.2 MPa) or more is required to operate the pump. If the supply pressure is less than 30 PSI (0.2 MPa), the pump may not operate properly.
 Pump Liquid Temperature Range: A"X", S"X", CR, NBR 32-180°F (0-82°C) TPEE 32-212°F (0-100°C)* TPO, PTFE 32-212°F (0-100°C) V"X" CR, NBR 32-180°F (0-82°C)
 TPEE 32-248°F (0-120°C) TPO, PTFE 32-212°F (0-100°C) G"X", D"X", 32-180°F (0-82°C) * 248F (120C) option available, consult factory.
 Ambient Temperature Range: 32-158°F (0-70°C)
 Slurry Recommendation: A"X", S"X" Particle Size: 0.04" (1mm) or less G"X", V"X" Flat valve type pumps are not available for use in slurry liquid
 Viscosity Limit: ~500 cps (0.5 Pa-s) (For applications requiring higher viscosity, please consult your distributor)

PERFORMANCE CURVES

— Flow
 - - - - Air

Conditions:
 4" (10 cm) flooded suction.
 Ambient temperature: 72°F (22°C)
 Liquid temperature: 63-68°F (17-20°C)

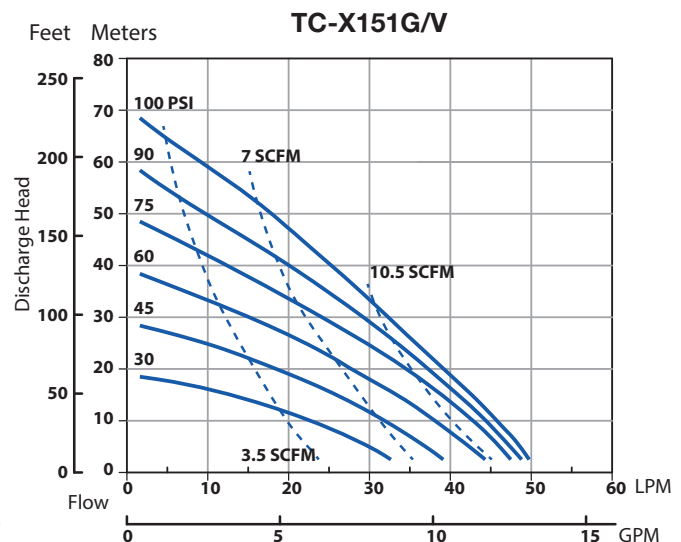
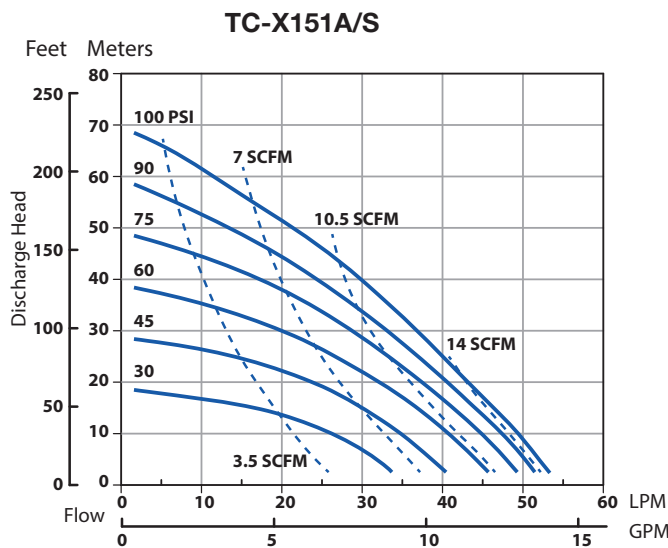

WET END MATERIALS

Code	Pump Wetted Parts	Diaphragm	Ball Valve/O-Ring	Flat Valve O-Ring	Valve Seat	Valve Stopper	Outer Diaphragm Plate	Center Body
AC	AL Alloy	Neoprene™	Neoprene™/BUNA	PTFE	AL	----	AL	Ryton®
AN		BUNA	BUNA					
AT		PTFE	PTFE					
AW		PTFE/EDPM backup (one piece)	PTFE					
AH		Hytre™	Hytre™/BUNA					
AS	Santoprene®	Santoprene®/EPDM						
SC	Cast SS	Neoprene™	Neoprene™/BUNA		SS316	----	SS316	
SN		BUNA	BUNA					
ST		PTFE	PTFE					
SW		PTFE/EDPM backup (one piece)	PTFE					
SH		Hytre™	Hytre™/BUNA					
SH	Santoprene®	Santoprene®/EPDM						
GC	GFRPP	Neoprene™	PTFE	BUNA	GFRPP	GFRPP (SS303*)		
GN		BUNA						
GT		PTFE						
GW		PTFE/EDPM backup (one piece)						
GH		Hytre™						
GS	Santoprene®							
VT	PVDF	PTFE		PVDF	PVDF	PVDF (SS303*)		
VW		PTFE/EDPM backup (one piece)						
VS		Santoprene®						
DT	Acetal	PTFE		Acetal	Acetal	Acetal (SS303*)		

AL Alloy	Aluminum Alloy (ADC12)
AL	Aluminum (A5056)
Neoprene™	Chloroprene Rubber (CR)
BUNA	Nitrile Rubber (NBR)
Cast SS	Cast Stainless Steel (SCS14)
*SS303	Stainless Steel (Insert material)
SS316	Stainless Steel Grade 316
GFRPP	Glass Fiber Reinforced Polypropylene
PTFE	Polytetrafluoroethylene (Teflon®)
PVDF	Polyvinylidene Fluoride (Kynar®)
Hytre™	Thermoplastic Polyester Elastomer (TPEE)
Santoprene®	Thermoplastic Polyolefin (TPO)
Acetal	Polyoxymethylene (POM)
Ryton®	Polyphenylene Sulphide (PPS)

DIMENSIONS

TC-X151A/S (max dimensions shown)

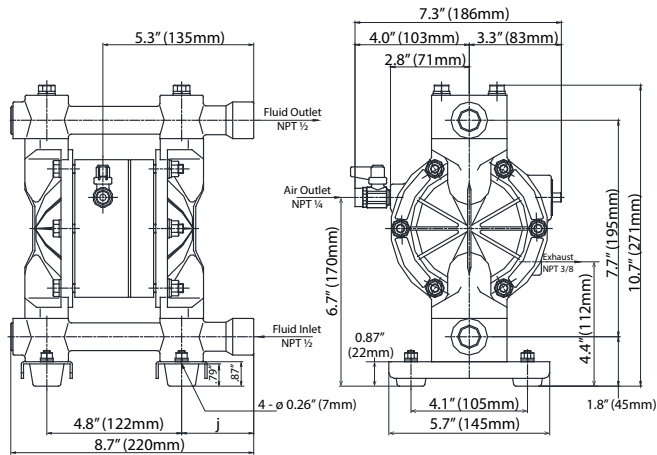

TC-X151G/V/D

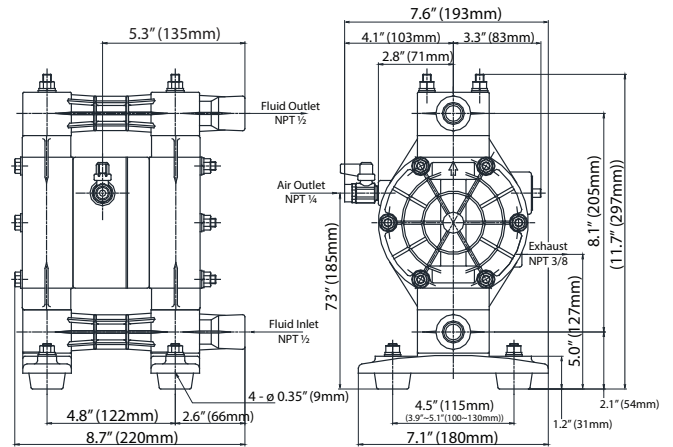

MODEL NUMBER NOMENCLATURE

